

ASSEMBLY INSTRUCTIONS

CORNER WORKSTATION
MODEL : OE 104 Left WH/DG





DOC. NO : RD-103-A1
REV. NO : A
REV. DATE : 25.03.2005

REV. : A DATE : 27-07-2015

Thanks you for purchasing this quality product. Be sure to lay all components on a soft and clean surface before assembly in order to avoid components from being scratched.

CAUTIONS :

1. Check contents against list for quantity.
2. Familiarize yourself with the components and hardware by reviewing the Assembly Instructions.
3. Do not over tightened the screws and bolts as it may damage the threads.
4. Keep all hardware parts out of the reach of children.

A		B		C		D		E	
	Minifix Bolt And Coating 11 Pcs		Klix Cam 11 Pcs		Housing Cap (shard) 11 Pcs		Grommet 1 Pc		Allen-Key 1 Pc

STEP 1

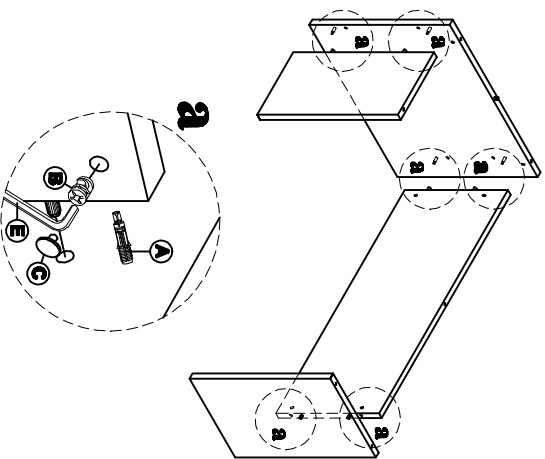

STEP 2

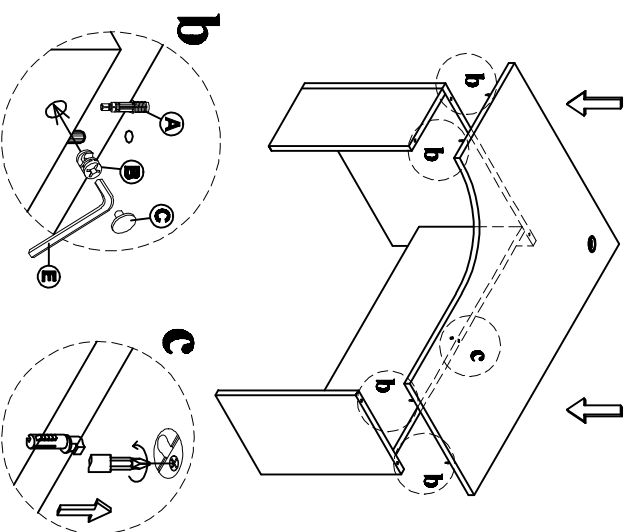

STEP 3

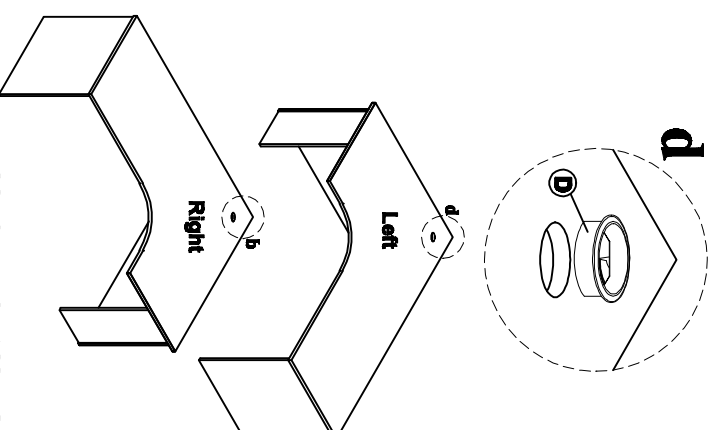

COMPLETED ASSEMBLY